

Yale Luna Pro / Luna Pro+ 3D人脸推拉锁 安装指导书
材质：封面126g铜版纸，内页100g双胶纸 双面单色印刷 装订册
尺寸：205*140mm 24页



Installation Guide

Yale Luna Pro+ / Pro

Yale Luna Pro+
FaceScan / CPU card /
Fingerprint / PIN code / Key

Yale Luna Pro
CPU card / Fingerprint / PIN
code / Key

Table of contents

1 Preparation before installation

1.1	Product parts list	01
1.2	Optional accessories	03
1.3	Door direction confirmation	05
1.4	Mortise installation preparation	06
1.5	Fixing handing direction	07
1.6	Reversing handing direction (if needed)	09
1.7	Installation of threaded pull tube, positioning plug and transmission plate	11
1.8	Main body handle cover removal	12
1.9	Door holes opening	12

2 Product installation

2.1	Mortise installation	13
2.2	Front body installation	14
2.3	Main body plate installation	15
2.4	Main body installation	16
2.5	Striker plate and striker box installation	17
2.6	Key installation	18
2.7	Acceptance test	19

* The pictures in this installation manual are for illustration purposely,
and the actual product or parts may vary. *

Preparation before installation

1.1 Product parts list

Product main parts

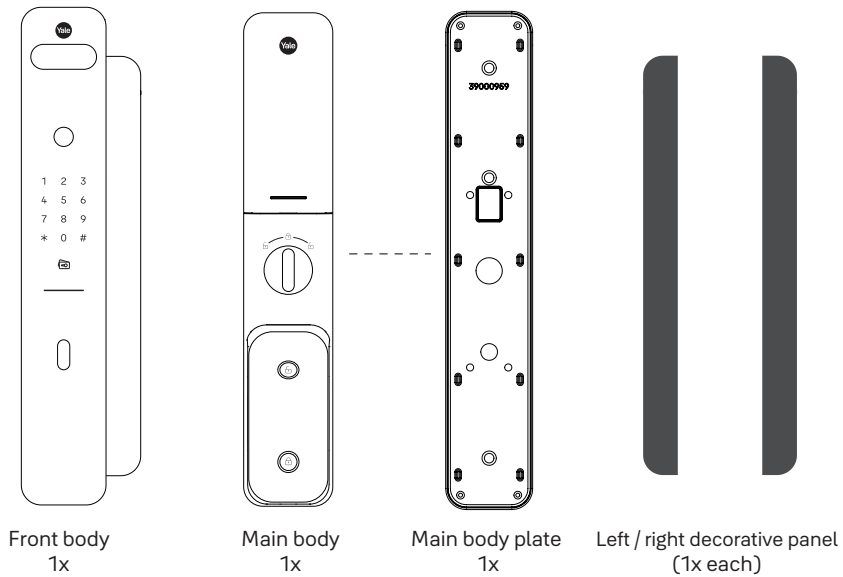

Mortise, striker plate, Striker box, screws

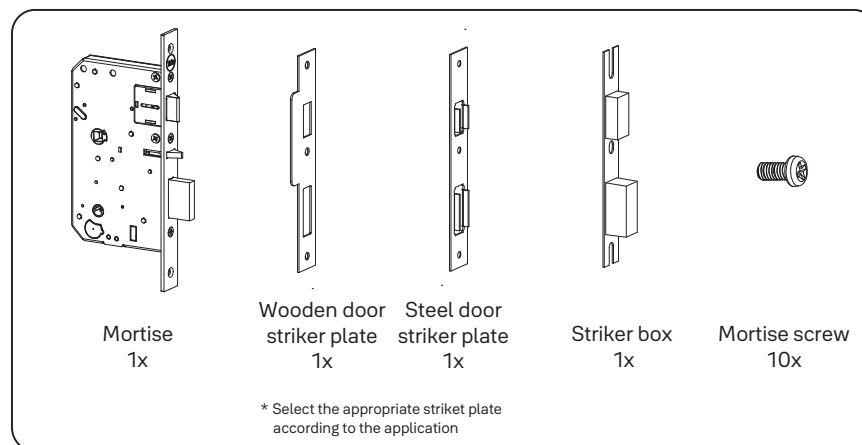

Installation Accessories Kit

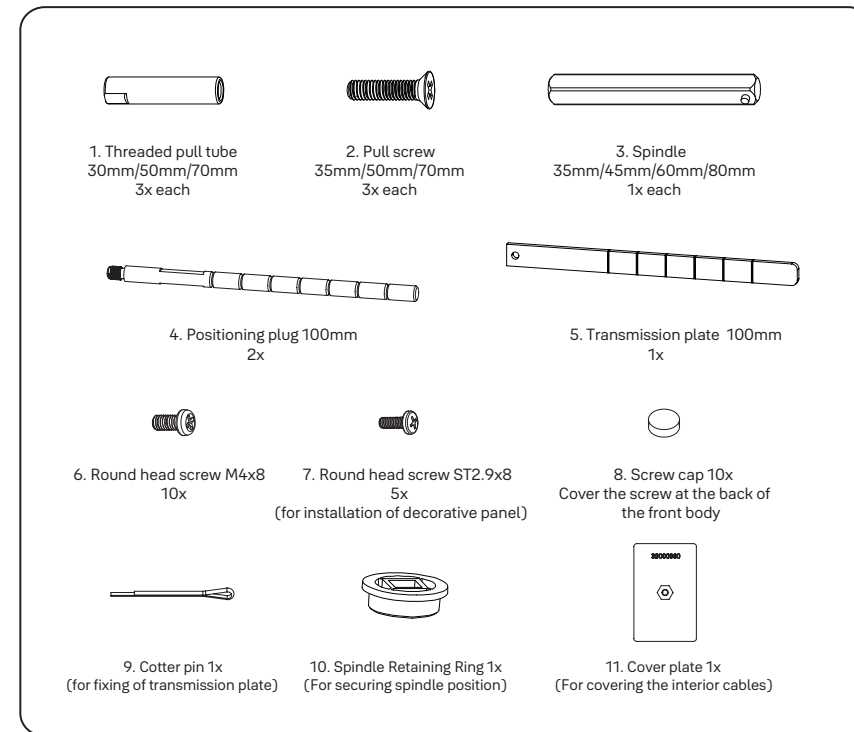

Accessories

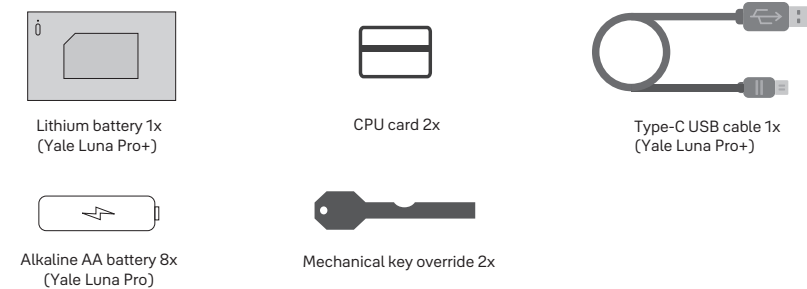

Note

- The battery type may vary depending on the model.
- Please do not use or test the mechanical key override before the completion of installation to avoid potential complications and damages.

1.2 Optional accessories

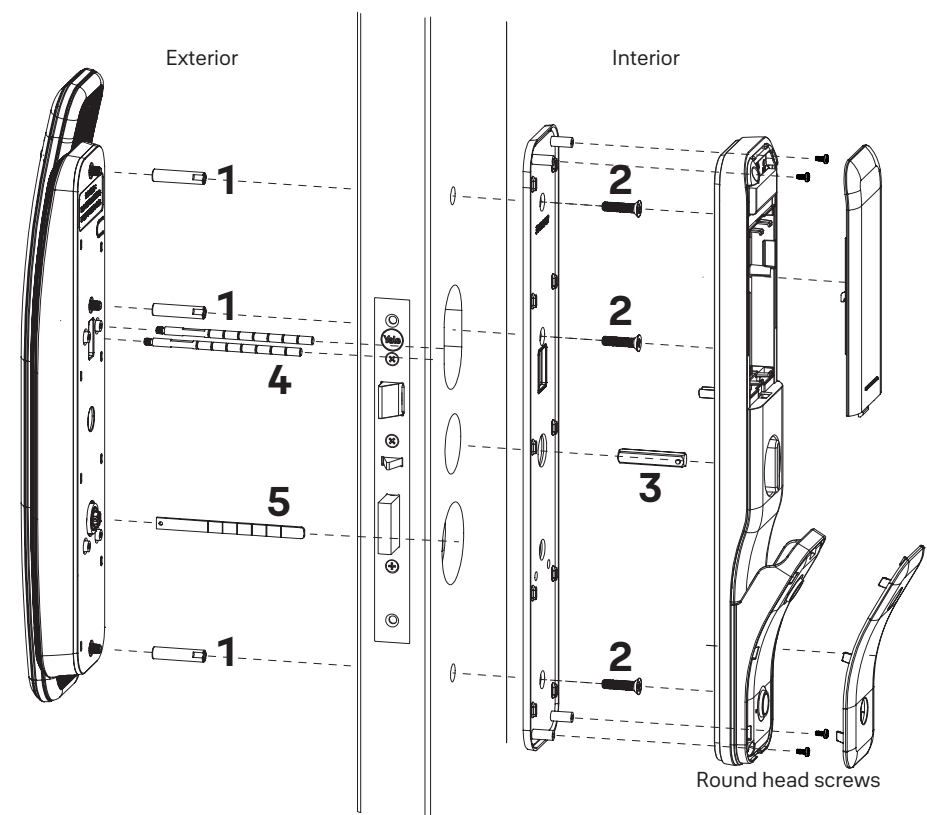

Table 1.2.1 Selection and customization of installation accessories

Door thickness (mm)	1 Threaded pull tube	2 Pull screw	3 Spindle	4 Positioning plug cut 7 sections cut 6 sections cut 4 sections cut 3 sections	5 Transmission plate cut 5 sections cut 3 sections
35-50	30	35	Please refer to Table 1.2.2		
51-70	50	35			
71-90	70	50			
91-100	70	70			

Remarks:

- ① Door thickness is the actual total thickness of the door.
- ② The default factory accessories package is only suitable for 35-100mm door thickness; other door thicknesses require customized accessories package

Table 1.2.2 Selection of spindle

Door thickness (mm)	3 Spindle	Remark
35-44	Length=35mm	L1≥17mm
45-59	Length=45mm	
60-79	Length=60mm	L1≥23mm
80-100	Length=80mm	

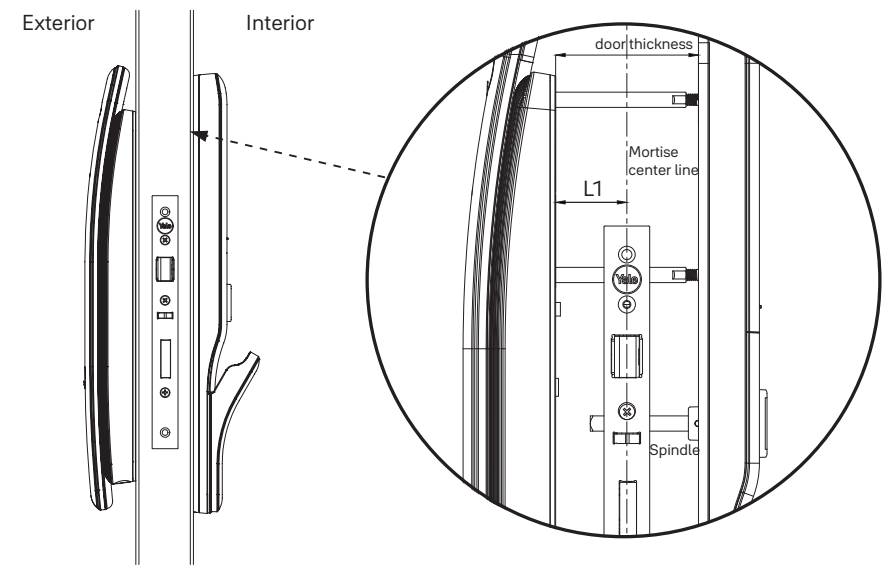

Note

- The distance from the mortise center line to the outdoor door edge is L1

1.3 Door direction confirmation

This product can be applied to doors with four opening directions: left inward-opening, left outward-opening, right inward-opening, right outward-opening. Take the person standing outside facing the door as the standard: if the hinge of the door is installed on the left side, then the door is a left opening door, and if the hinge on the door is installed on the right side, then the door is a right opening door.

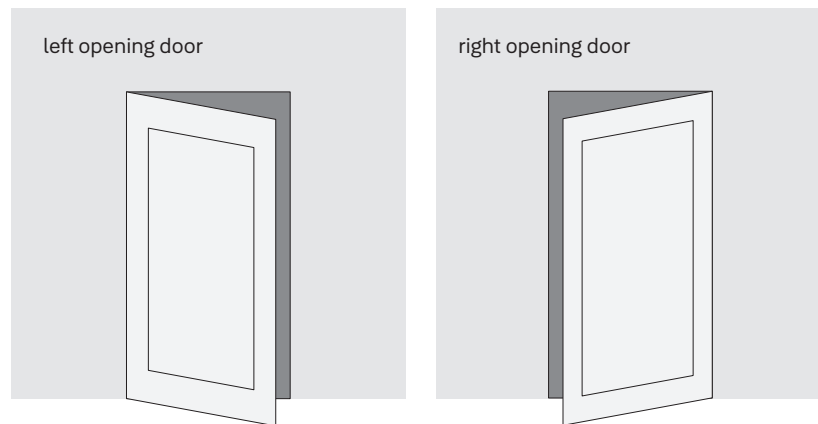

Outward door - Door is pulled outwards.
Inward door - Door is pushed inward.

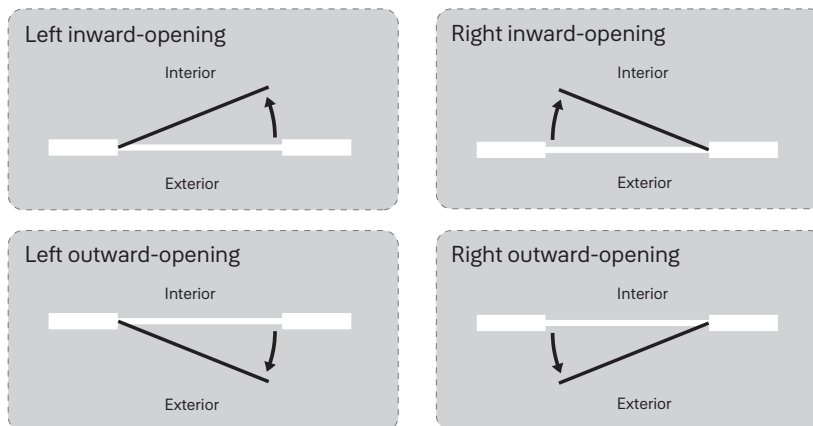

The latch bolt direction is determined by the door opening direction, either left inward-opening, right inward-opening, left outward-opening or right outward-opening



Note

➤ Recommended door gap for installation: $3\text{mm} \leq \text{door gap} \leq 8\text{mm}$

1.4 Mortise installation preparation

To determine the latch direction by checking the door opening direction, either left inward-opening, left outward-opening, right inward-opening, right outward-opening, this is to ensure that when the door is closed, the latch bolt can be retracted under the pressure of door frame.

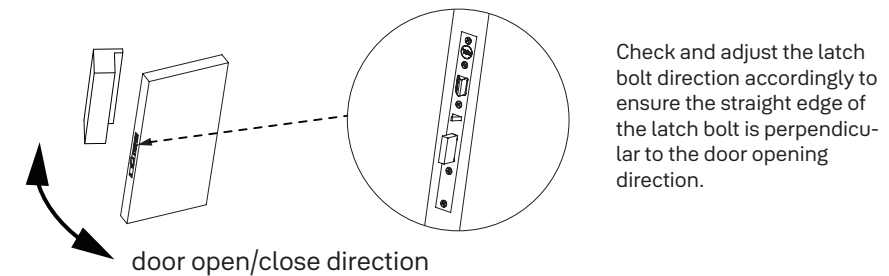

Check and adjust the latch bolt direction accordingly to ensure the straight edge of the latch bolt is perpendicular to the door opening direction.

Latch bolt reversing guide as below

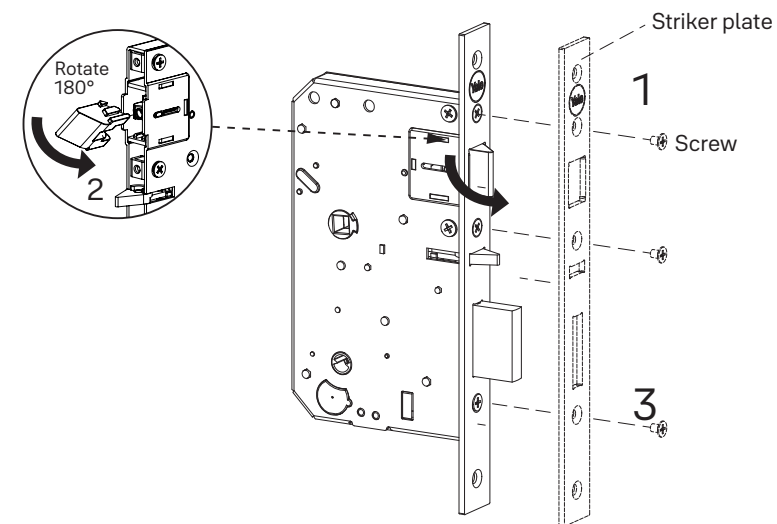

Step 1. Use a tool to remove screws as show in picture, and disassemble striker plate from mortise.

Step 2. Remove by pulling out the latch bolt, change the latch bolt direction by rotating 180° manually, and reinsert the latch bolt to the mortise.

Step 3. After reversing, reinstate the striker plate and screws.

1.5 Fixing handing direction

Handle direction to be determined by door handing direction.

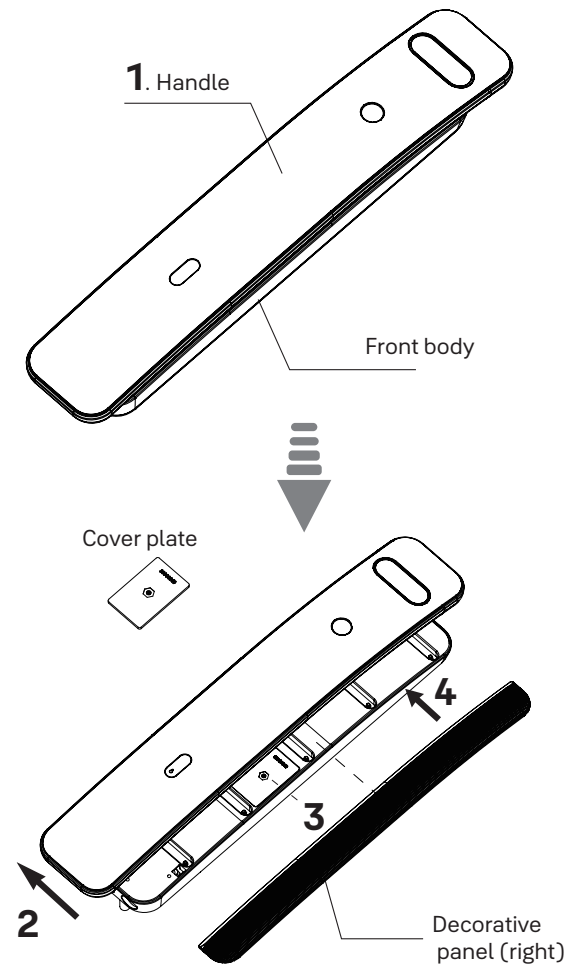

Step 1. Handle is positioned at the center by default.

Step 2. Slide the handle to the desired position based on the door handing direction.

Step 3. Secure the cover plate with round head screws (M4).

Step 4. Ensure the decorative panel is secured into the decorative panel.

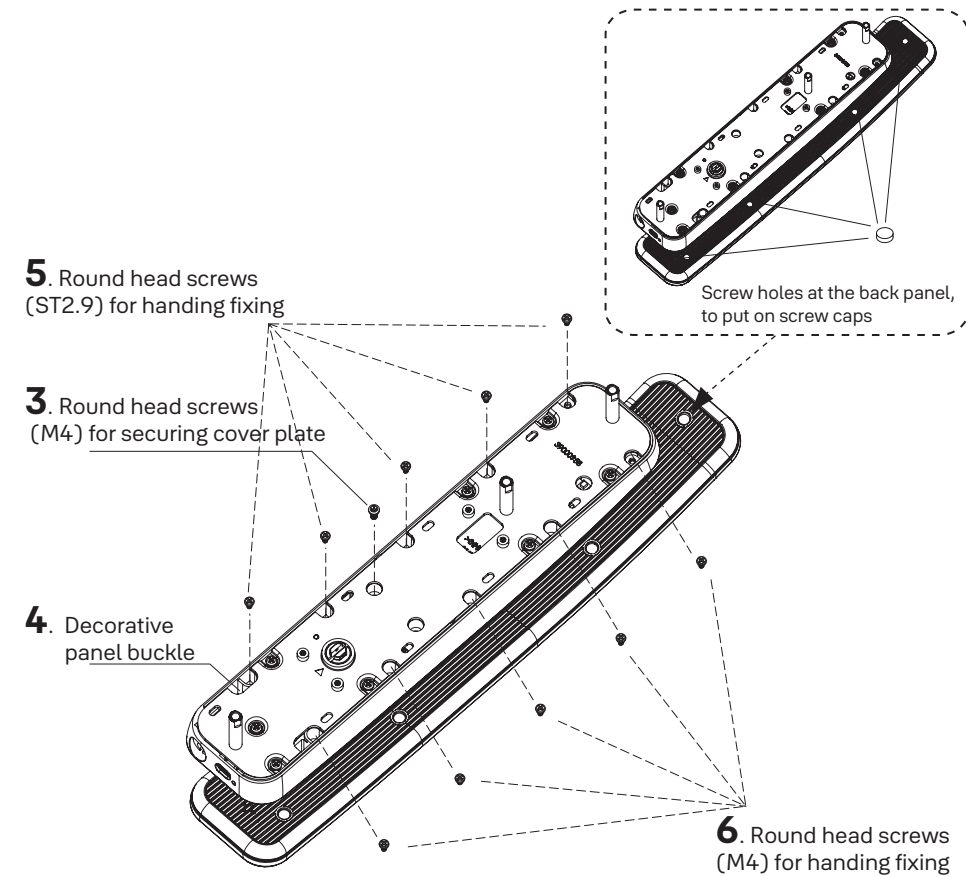

Step 5. Secure the corresponding decorative panel with round head screws (ST2.9).

Step 6. Secure the handle with the round head screws (M4)

Note

- For right-opening door, slide the handle to the right; for left-opening door, slide the handle to the left.

1.6 Reversing handing direction (if needed)

If you need to change the door opening direction due to ie. changing of the door, you will need to reverse the door handing direction.

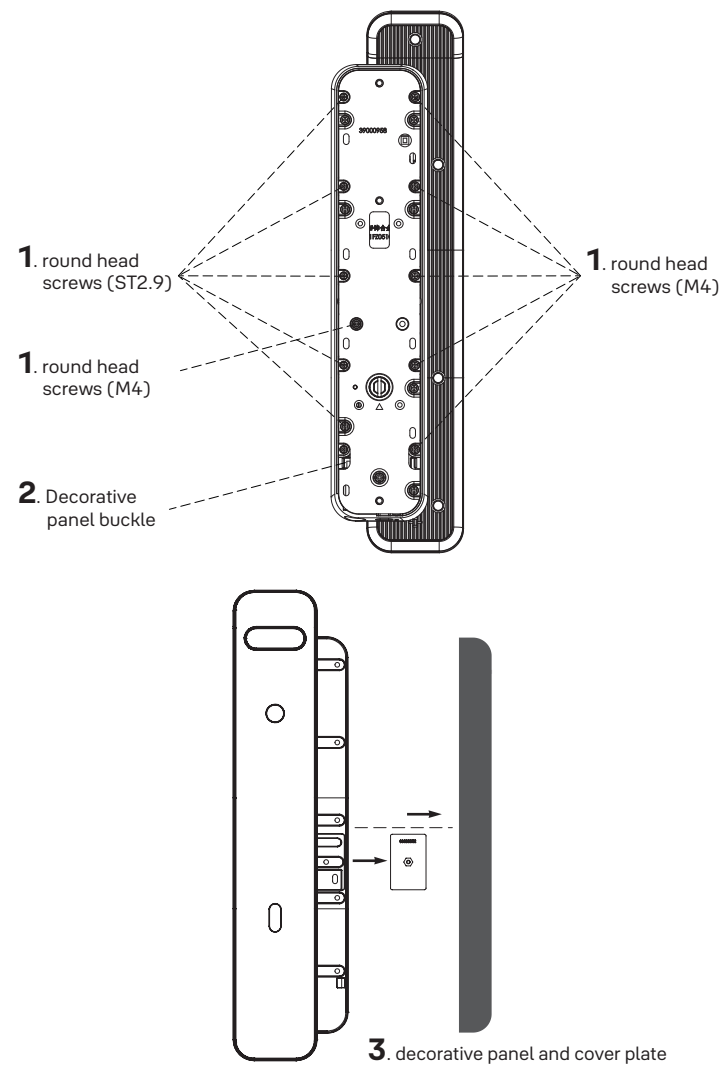

Step 1. Unscrew the handing fixing screws and the cover plate screw at the back of the front body.

Step 2. Push out the decorative panel from the buckle.

Step 3. Disassemble the decorative panel and cover plate.

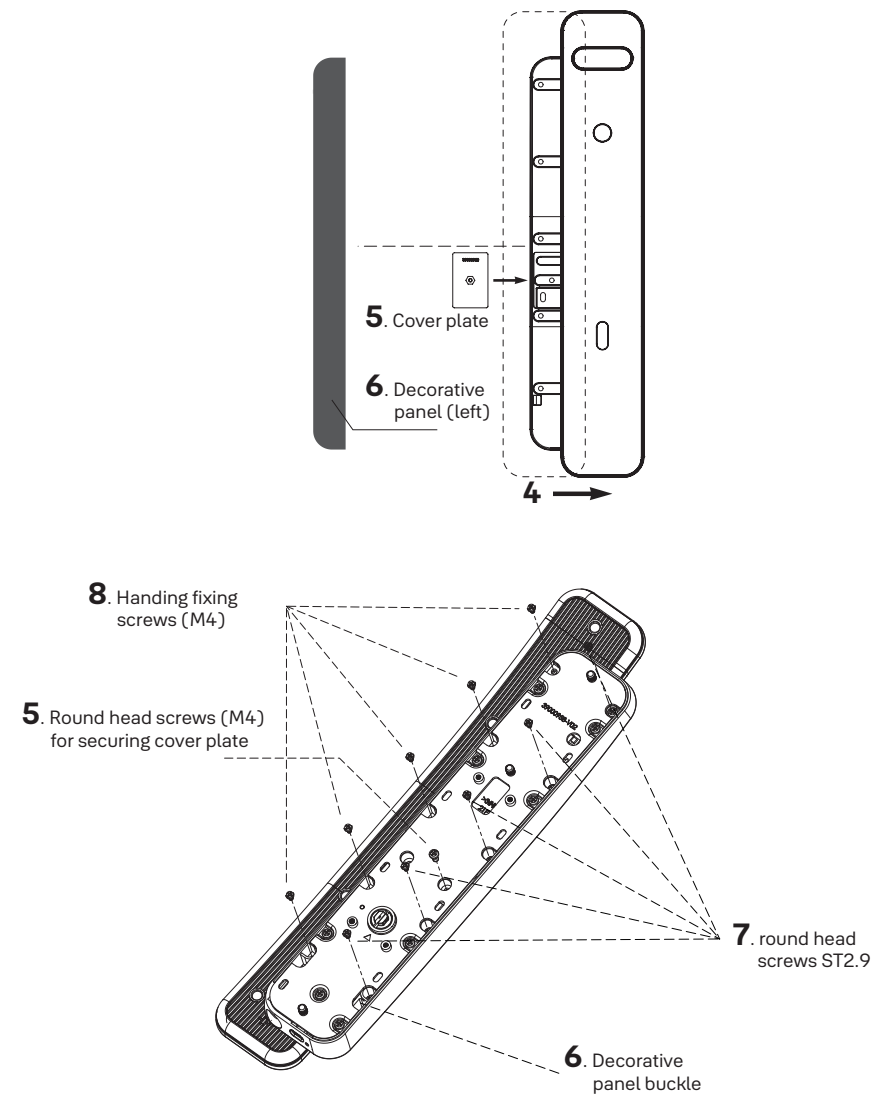

Step 4. Slide the handle to the opposite position.

Step 5. Secure the cover plate with round head screw (M4).

Step 6. Ensure the decorative panel is secured into the decorative panel buckle.

Step 7. Secure the corresponding decorative panel with round head screw (ST2.9)

Step 8. Secure the handing fixing screws (M4)

1.7 Installation of threaded pull tube, positioning plug and transmission plate

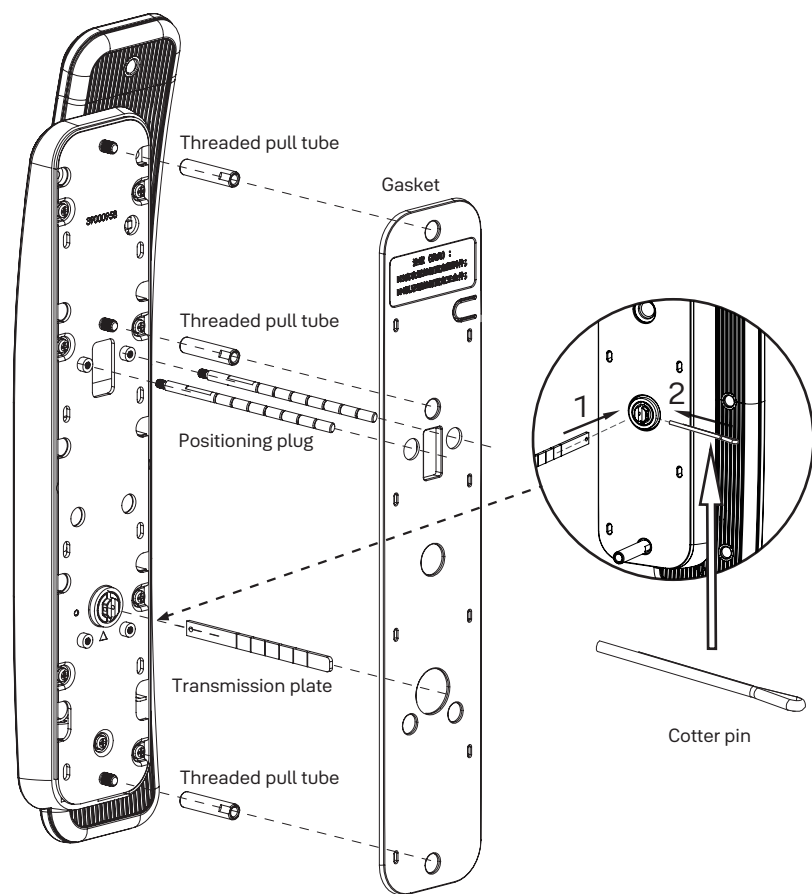

- Step 1. Insert transmission plate
- Step 2. Bend the cotter pin with a tool to secure the transmission plate.
- Step 3. Cut the positioning plug to the required length according to Table 1.2.1 in section 1.2

1.8 Main body handle cover removal

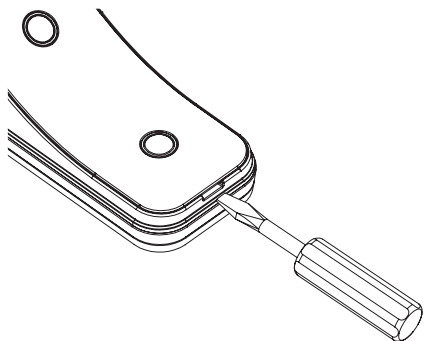

Before installation, use a flat-headed screw driver to detach the handle cover on the main body as shown in the picture above to expose the screw holes for installation later.

1.9 Door holes opening

Bore holes on the door using the installation template. Do not close the door during the installation of the product.

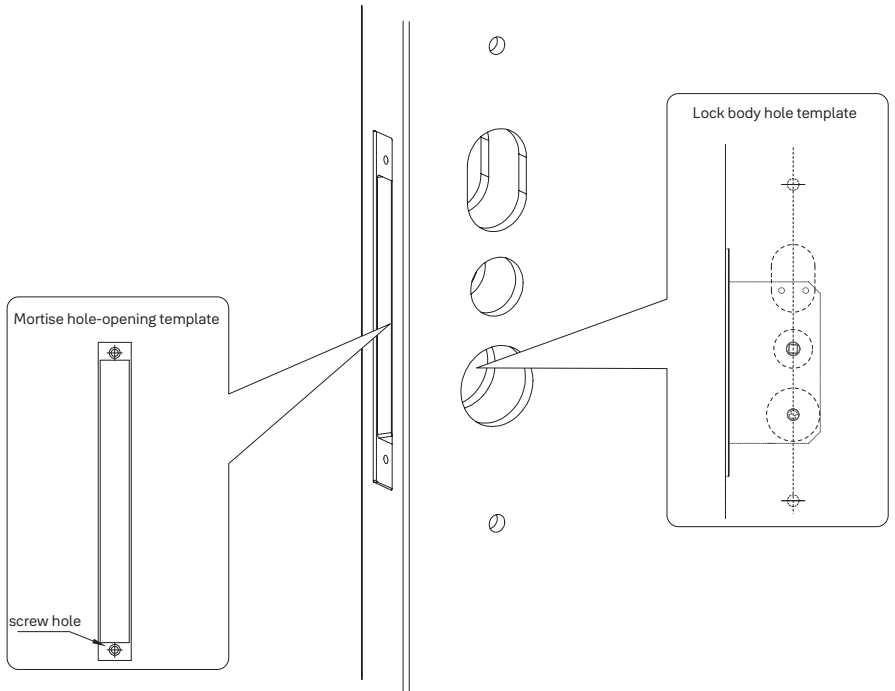

Product installation

2.1 Mortise installation

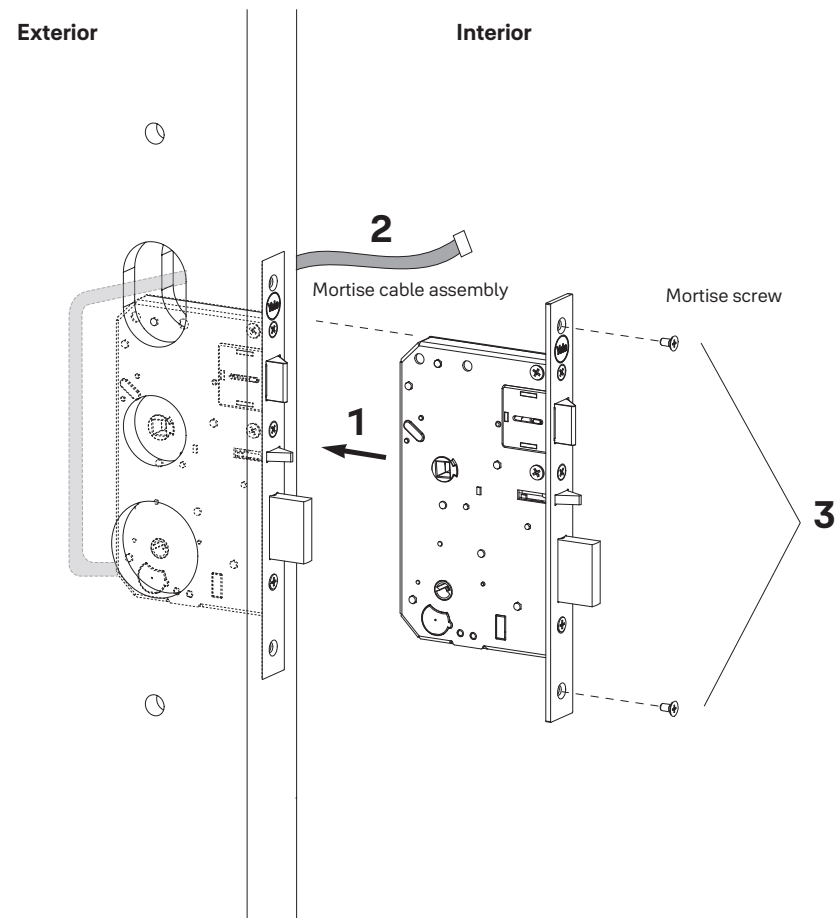

- Step 1. Make hole on the door according to the template provided, insert mortise into door panel.
- Step 2. Ensure the mortise cable is pulled out gently to the interior side of the door through the top hole.
- Step 3. Secure the mortise with the two mortise screws.

2.2 Front body installation

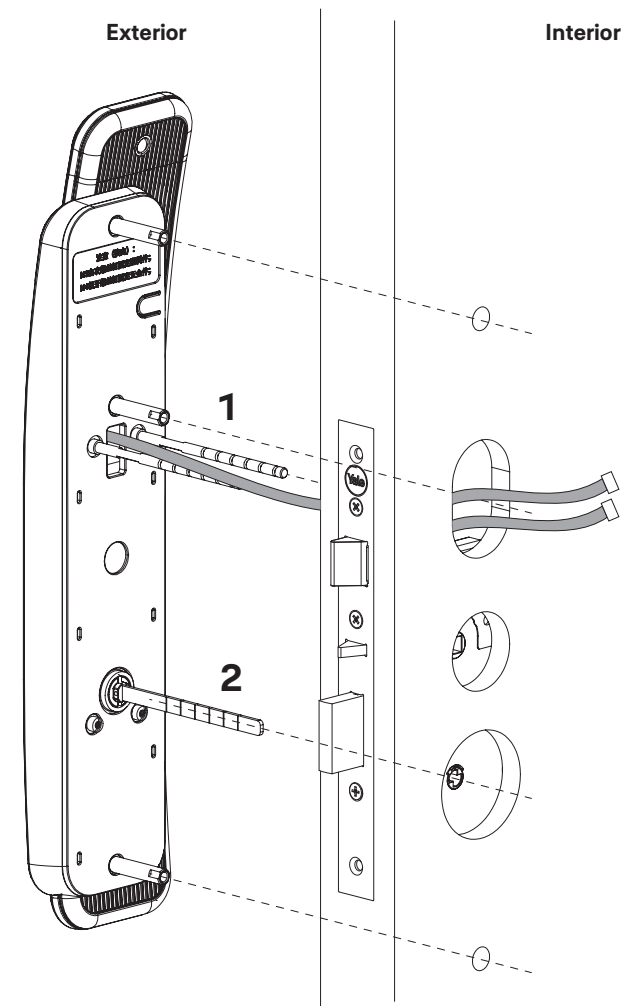

- Step 1. Pull through the front body cable assembly through the top hole as shown in the picture
- Step 2. Align the positioning plug and threaded pull tube to the respective holes, and ensure the front body gasket is tightly secured on the door panel.

2.3 Main body plate installation

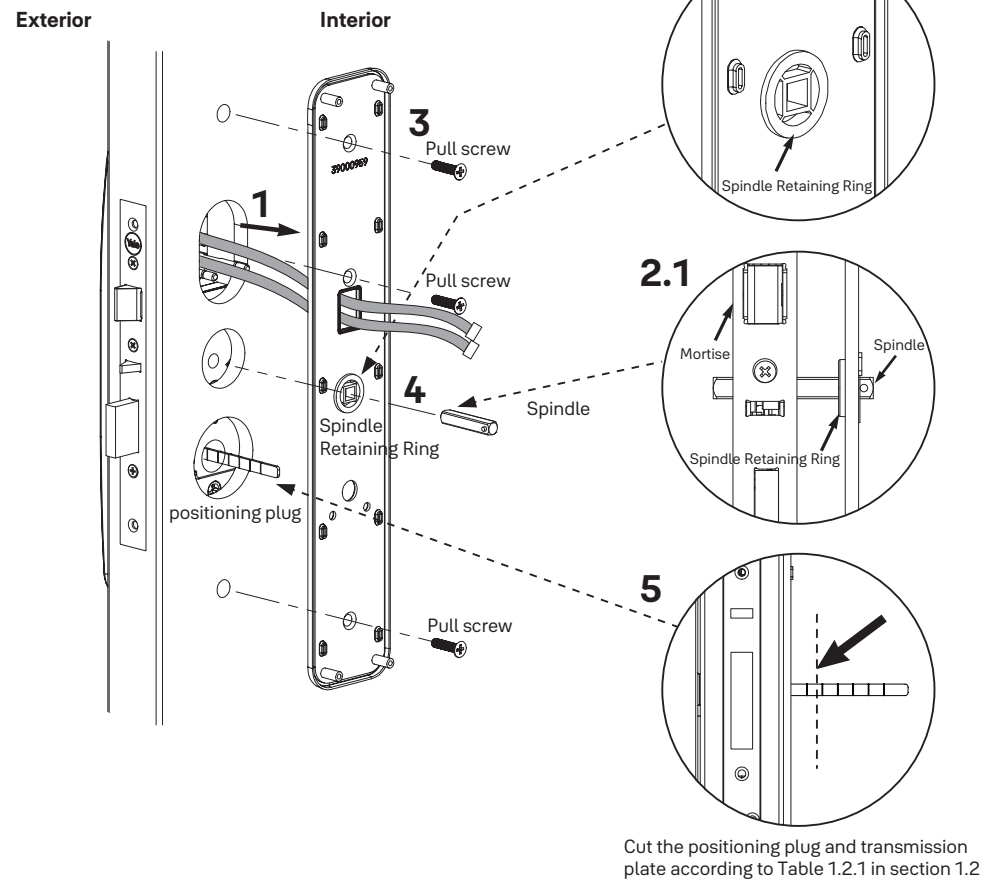

- Step 1. Pull both cable assembly through the main body plate
- Step 2.1. Place the spindle retaining ring to the hole as shown in the picture.
- Step 2.2. Insert the spindle into the mortise through the spindle retaining ring
- Step 3. Secure the main body plate with the pull screws
- Step 4. Remove the spindle retaining ring and the spindle
- Step 5. Cut the transmission plate to the required length according to Table 1.2.1 in section 1.2

2.4 Main body installation

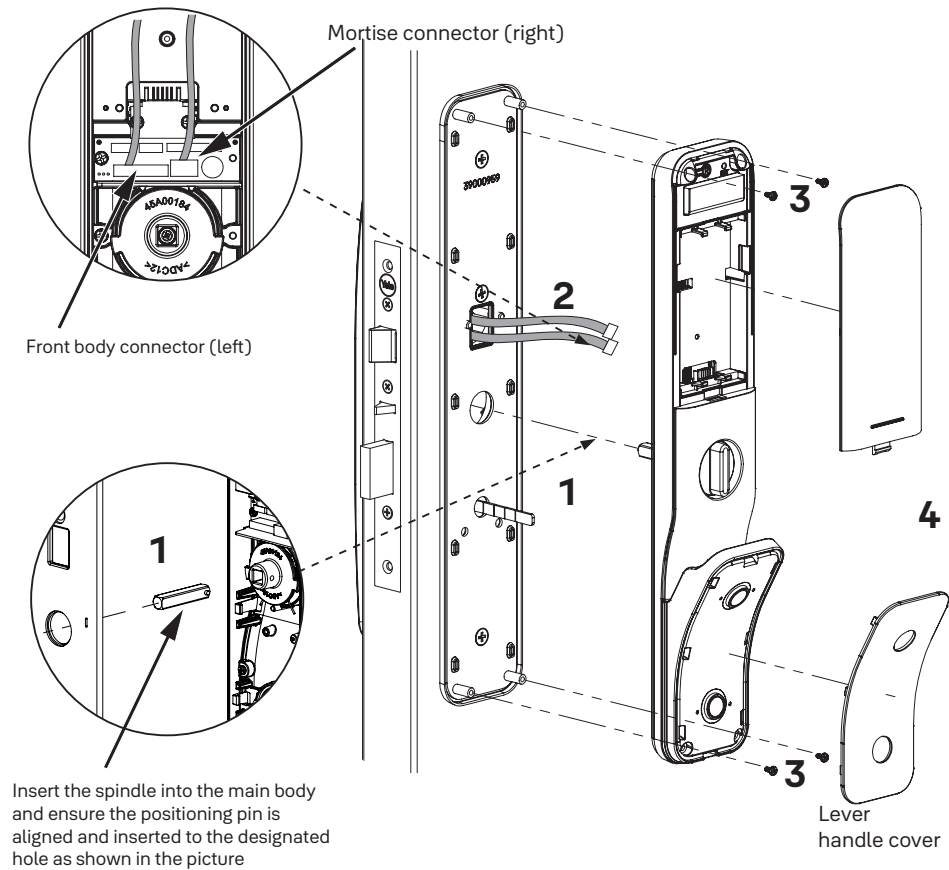

- Step 1. Insert the spindle into the main body. Make sure the positioning pin is aligned and inserted to the designated hole to secure the spindle
- Step 2. Connect the cable assemblies to the respective connectors on the main body. Tuck the excess cables into the door panel
- Step 3. Secure the main body with the round head screws (M4)
- Step 4. Install the handle cover then the battery

2.5 Striker plate and striker box installation

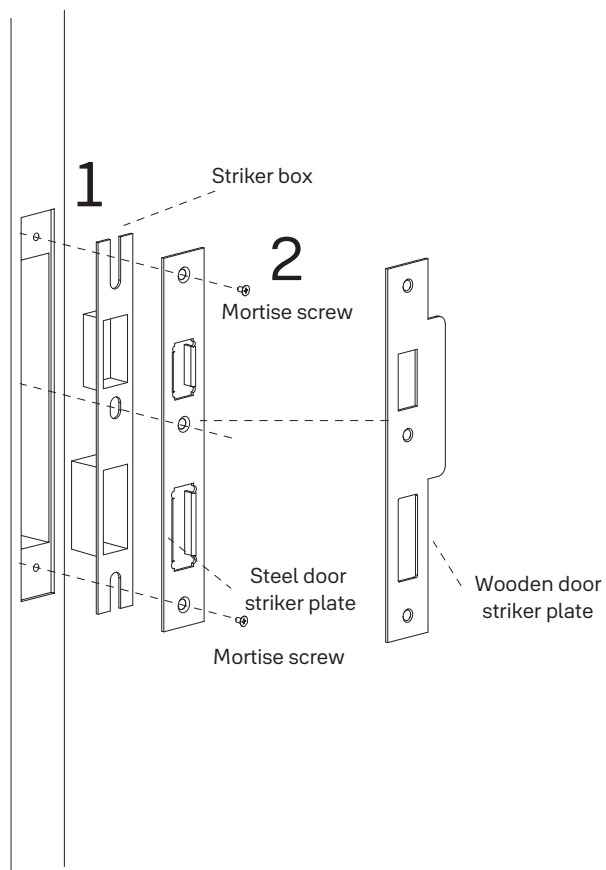

Step 1. Make a hole on the side jamb according to the installation template provided

Step 2. Secure the striker box with the correct striker plate



➤ Striker box is needed for wooden door installation only.

2.6 Battery installation on main body

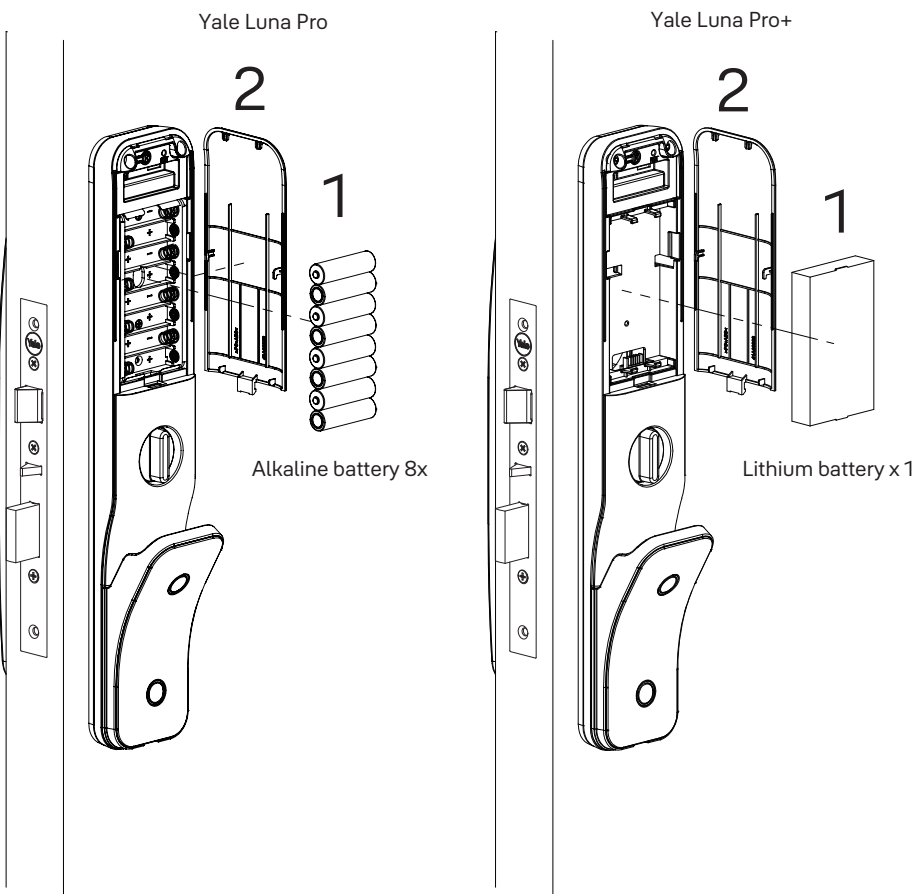

Step 1. Install the battery.

Step 2. Close battery cover



➤ To open to battery cover, please press on the bottom-center of the cover (to release the hook) and slide upward.

2.7 Acceptance test

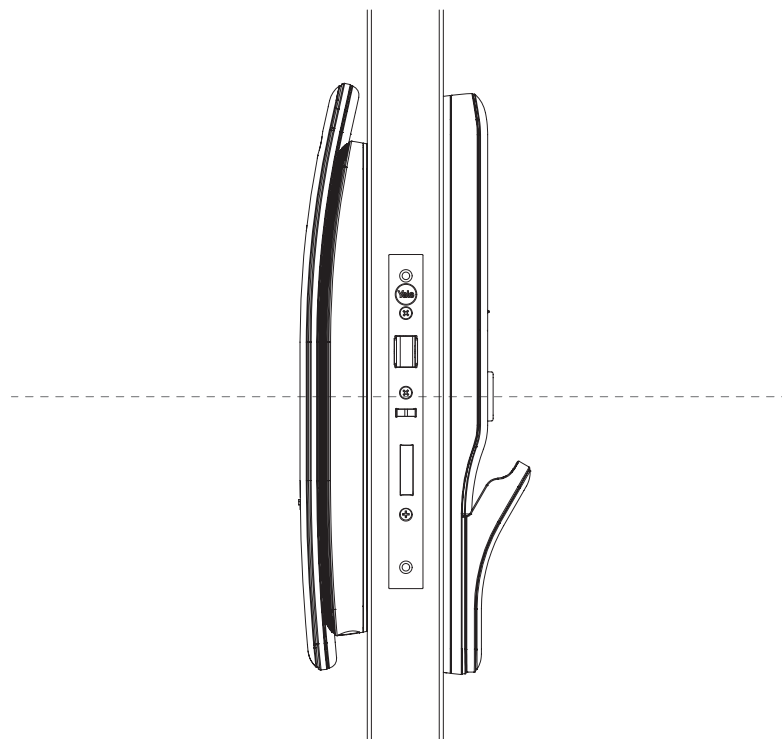

After the installation of the product is completed, please conduct an acceptance test.

1. Power on and change the administrator password
2. Front body and main body are parallel with the side jamb
3. Test and verify the connection and the installation of the manual thumb turn, mechanical key override and unlock/lock button
4. Test and verify the functionality of the deadbolt from both the front body and the back body
5. Pull the front body handle hard and ensure no false tampering alarm is triggered
6. Check the door panel condition, ensure no swaying after the deadbolt is protruded into the side jamb
7. Check the functionality of credentials: PIN code, FaceScan (Yale Luna Pro+ only), fingerprint scan, CPU card.
8. Check the functionality of other components (networking modules, if any)



- Do not conduct the acceptance test with the door closed (except step 6)